

RECOMMENDED PCB LAYOUT

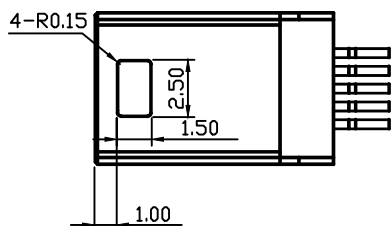
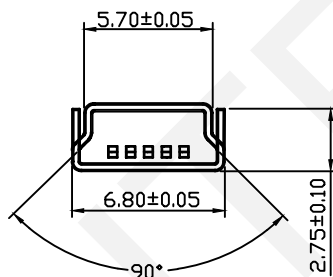
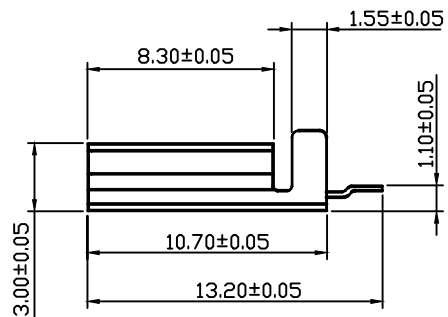

Material

Housing: Thermoplastic, UL94V-0 PTB/LCP, Black/White

Contact: Copper Alloy C2680,

Shell: Copper Alloy/Steel, Nickel Plated/Tin-Lead Plated

Electrical:

Voltage Current Rating: 1.5AMP, 30V AC.

Insulation Resistance: 1000MΩ Min.

Contact Resistance: 30mΩ Max.

Dielectric Withstanding Voltage: 500 V AC

Temperature Range: -35°C TO +85°C.

Mechanical:

Mating Force: 3.5KG Max.

Unmating Force: 1.0KG Min.

Order Information

RHTAY29-5MA-B-R

Model

Serial Number

Color: B=Black

R=Reel Packing

RHTECP NINGBO RHT ELECTRONIC CO.,LTD

UNITS:mm	SHEET SIZE: A4		SCALE:---	DRWN BY PAN
0~3	3~18	18~50	50~120	CHK'D BY FENG
±0.12	±0.15	±0.3	±0.5	APPR BY ZHAN

MINI USB TYPE B PLUG Male,SMD,MID MOUNT

THIRD ANGLE PROJECTION

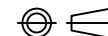

RHTAY29-5MA-B-R