

**Material**

Housing: High Temperature Thermoplastic,  
UL94V-0 LCP, Black/White.

Contact: Copper Alloy C2680

Shell: Copper Alloy C2680/SPCC

**Finish:**

Contact: Plated Gold In Mating Area; Tin On Solder Tails

Shell: Nickel Plating

**RECOMMENDED PCB LAYOUT**  
TOLERANCE: ±0.05mm

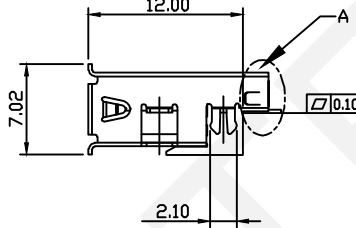
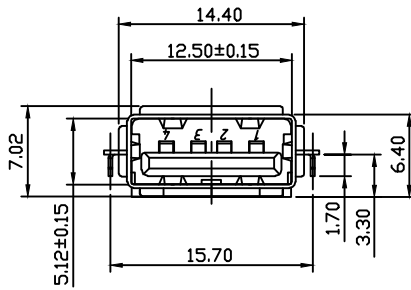

**Electrical:**

Current Rating: 1.5A/Contact Terminal.

Voltage Rating: 30V DC

Contact Resistance: 30mΩ Max.

Dielectric Withstanding Voltage: 500 V AC AT Sea Level.

Insulation Resistance: 1000MΩ Min.

Connector Mate And Unmated Force

Mate Force: 3.75kgf Max.

Unmated Force: 1.02kgf Min.

Terminal Retention: 1.2kgf Min

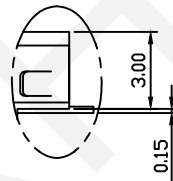
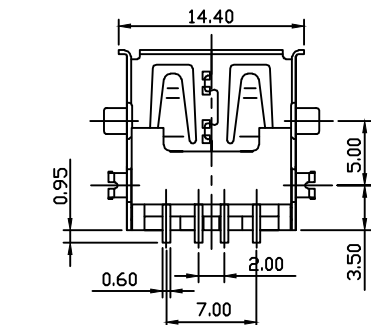

DET'A\*2:1

**Order Information**

RHTAY816-B-R

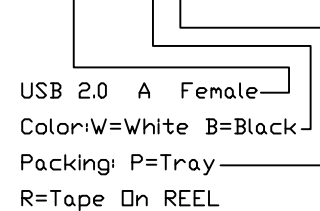

**RHTECP** NINGBO RHT ELECTRONIC CO.,LTD

UNITS:mm	SHEET SIZE: A4		SCALE:---	DRWN BY PAN
0~3	3~18	18~50	50~120	CHK'D BY FENG
±0.12	±0.15	±0.3	±0.5	APPR BY ZHAN

CONN COM TYPE A USB Female MD MOUNT 3.4mm	
THIRD ANGLE PROJECTION 	RHTAY816-X-X